

# Poseidon CV Installation Instruction

**NEKO**

Please read these instructions carefully before commencing installation and retain for future reference. If in doubt, we advise that you consult a qualified electrician to install the product. These products must not be modified. If any modification is made it may invalidate the warranty and may render the product unsafe. All electrical installations must be carried out according to current IEE Wiring Regulations.

## Important safety Notes

1. Switch off the electricity at the mains before commencing installation or lamp change and (if a fuse box is used) remove the appropriate circuit fuse to avoid accidental switching on of the mains supply.
2. Connect to a LED driver in accordance with IEE regulations.
3. Make sure all connections are tight with no loose strands.
4. Ensure fire regulations are not breached when fitting your lights.

## Warning:

1. Please ensure that the packaging is disposed of in a safe environment.
2. If cable is defective, do not use or exchange the cable, please contact your local dealer.
3. Do not look at the lighted lamp directly.
4. We do recommend that a qualified electrician should be used to install the products.

Cover A



Cover B

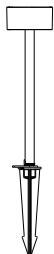

Cover C



## Installation Process

### 2. Spike with Pedal Installation

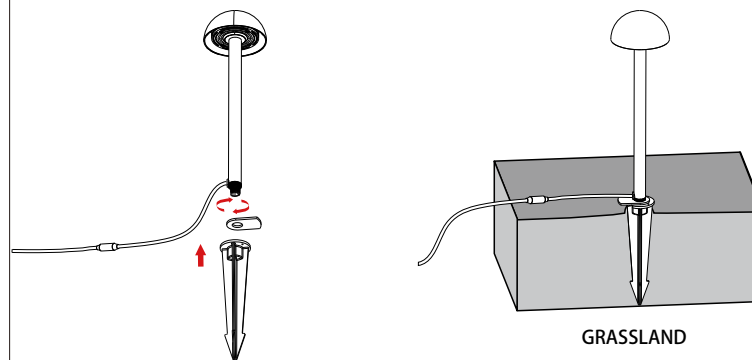

### 3. Base Installation

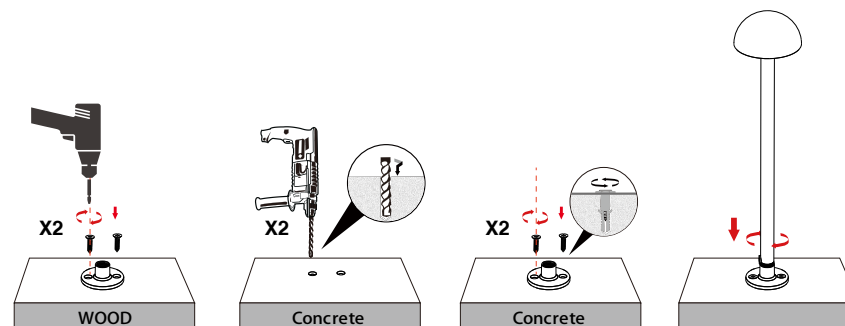

### 4. Interchangeable Covers

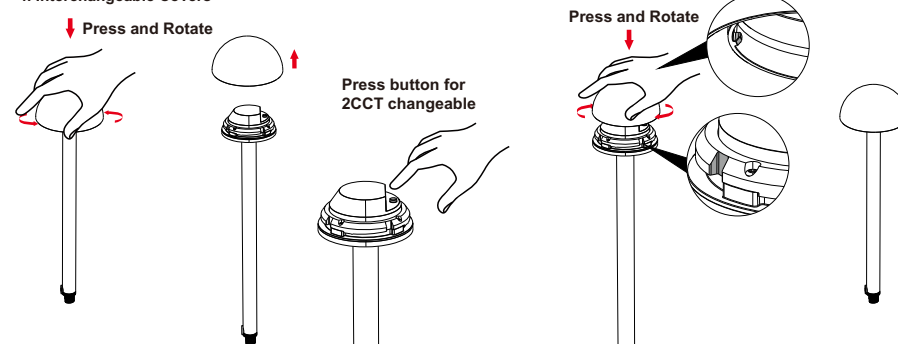

CE



IP66

### 1. Fix the installation bracket on the mounting surface

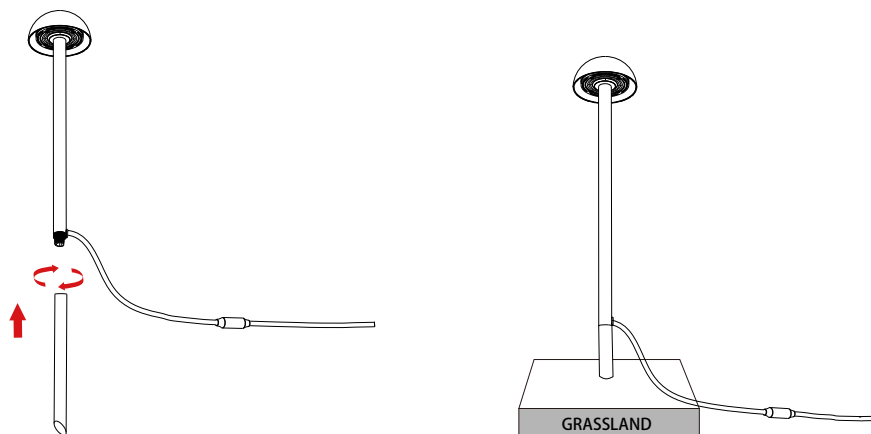

CE

NEKO LIGHTING AG  
www.nekolighting.com

CE

NEKO LIGHTING AG  
www.nekolighting.com

**Installation Process**

5.Connect the cable to terminal blocok (Sold separately)

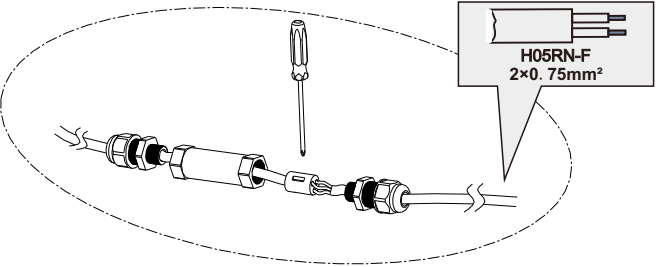

6.Use the following connection style

