

NEKO

Important safety Notes

- Warning:**

-

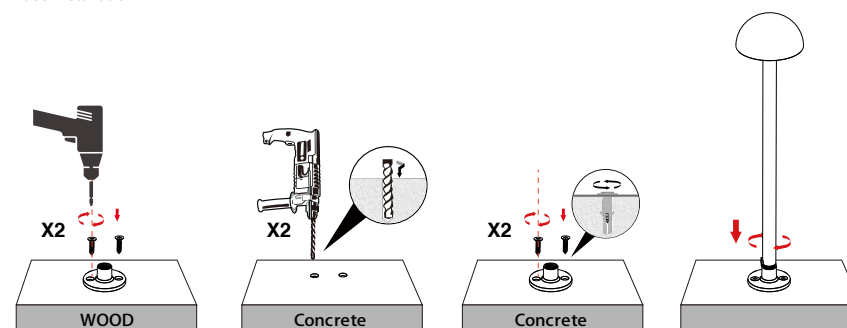

4. Interchangeable Covers

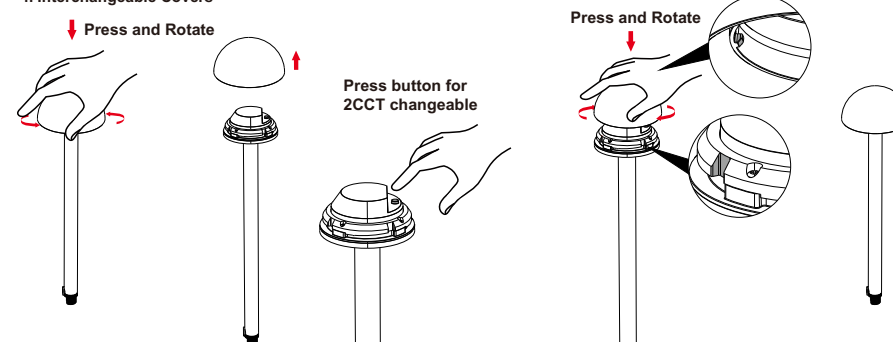

IP66

1. Fix the installation bracket on the mounting surface

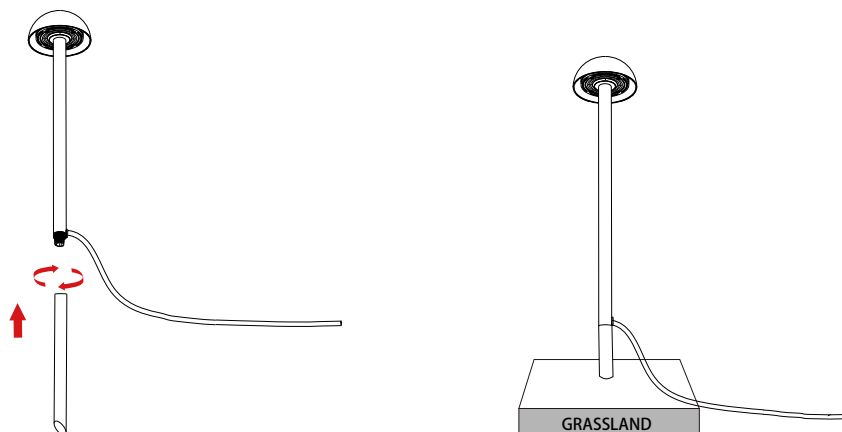

NEKO LIGHTING AG
www.nekolighting.com



NEKO LIGHTING AG
www.nekolighting.com

Installation Process

5.Connect the cable to terminal blocok (Sold separately)

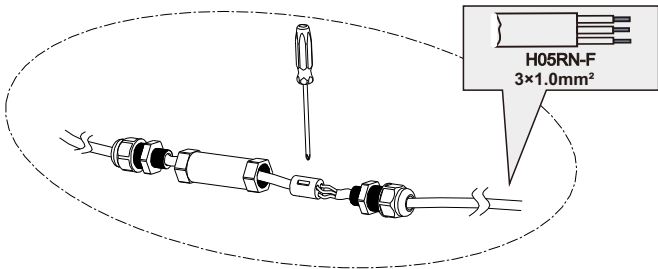

6.Use the following connection style

